

WATER PROOFING AS PER ITEM NO. 22.7 (I) OF DSR-2016.
LEAD IN SLOPE TOWARDS RAIN WATER DRAIN PIPE.

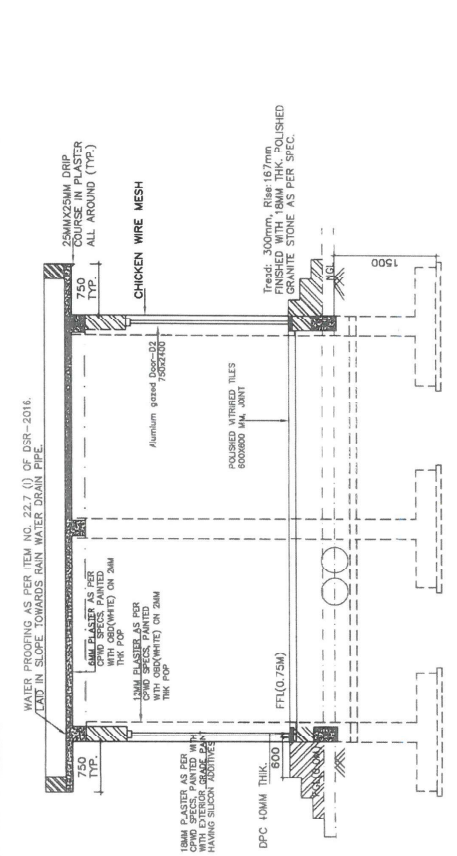

SECTION A-A

SECTION C-C (6M)

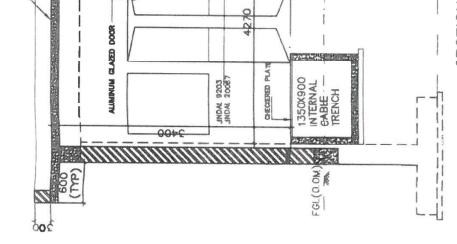
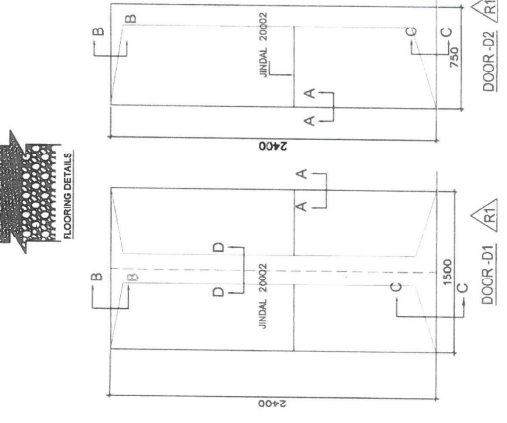
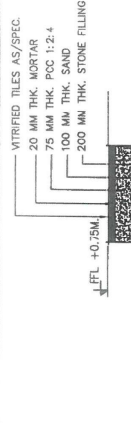

DOOR-D2 (R)

DOOR-D1 (R)

GENERAL NOTES:

- ALL DIMENSIONS ARE IN MM AND LEVELS ARE IN MTR.
- ALL EXTERNAL SURFACE SHALL HAVE 18MM PLASTER AS PER CPWD SPECS. PAINTED WITH WITH EXTERIOR GRADE PAINT HAVING SILICON ADDITIVES.
- THE WIRE MESH SHALL BE CONNECTED WITH EARTHING SYSTEM THROUGH 75X25MM FLAT FIXED ON DIAGONALLY OPPOSITE COLUMNS ON ITS OUTER SURFACE.
- INTERNAL CABLE TRENCH SHALL HAVE SLOPE OF 1:1000 TOWARDS THE EXTERNAL CABLE TRENCH.
- ALL MISC. STEEL SHALL BE PAINTED WITH ONE COAT OF ANTI CORROSIVE PAINT OVER APPROVED PRIMER COAT.
- INTERNAL CABLE TRENCH LAYOUT SHALL BE VERIFIED/MODIFIED AS PER THE INTERIOR LAYOUT.
- ALL WELDS ARE 8MM FILLET CONTINUOUS WELD UNLESS OTHERWISE SPECIFIED.
- ROOF CHICKEN WIRE MESH SHALL BE PROVIDED FOR OUTER WALL AND INTERNAL WALLS.
- FOR OPENING OF AIR CONDITIONER SUITABLE LOCATION AND SIZE TO BE DECIDED AT SITE.
- ALL STEPS SHALL BE FINISHED WITH 18MM THK. POLISHED GRANITE STONE AS PER SPECIFICATION.

11. All doors and windows shall be of OPVC type as per specification. (TS) 16/05/2020

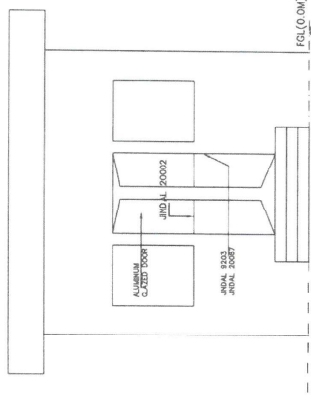

VIEW Y-Y

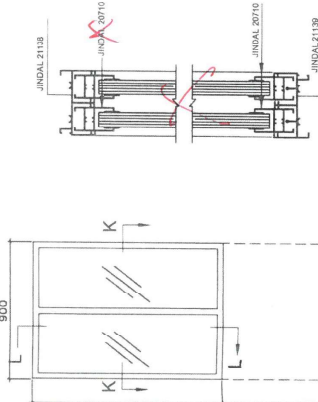

SECTION L-L (2-TRACK)

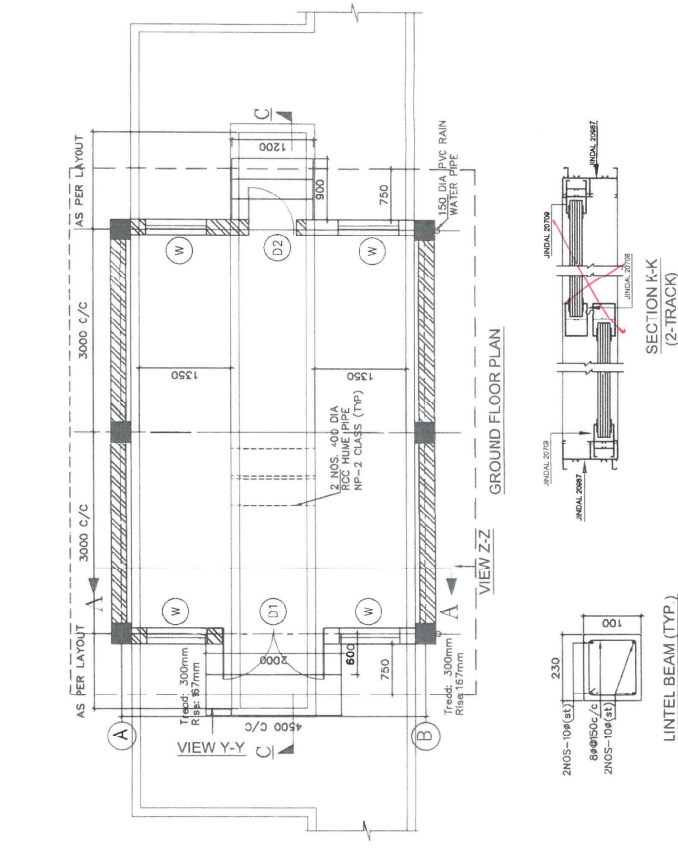

GROUND FLOOR PLAN

VIEW Y-Y

VIEW Z-Z

LINTEL BEAM (TYP)

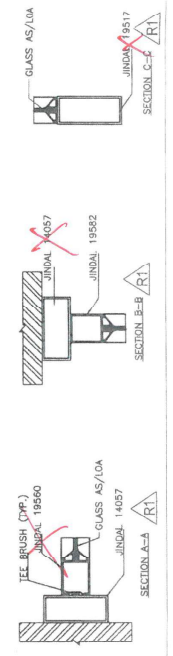

RELEASED FOR TENDER/CONSTRUCTION	POWER GRID CORPORATION OF INDIA LIMITED (A Government of India Enterprise)
TITLE: STANDARD PANEL ROOM (6 M)	
SUB TITLE: STANDARD SWITCHBOARD PANEL ROOM GENERAL ARRANGEMENT DETAIL OF PANEL ROOM	
DRAWING NO: C/ENGG/STD/PR/2017 (01 OF 03)	SCALE: NTS
DATE: 16/05/2020	REV: 01

REVISED AS MARKED (R)

REV.	DESCRIPTION	PREP.	REV.	REV.	REV.	REV.	DATE
0	REVISED AS MARKED						
1							
2							
3							
4							
5							
6							
7							
8							
9							
10							
11							
12							
13							
14							
15							
16							
17							
18							
19							
20							